

**KIT**

**A**



**READ FULLY BEFORE BEGINNING  
- IT'LL MAKE MORE SENSE!**

**PERIODICALLY CHECK THE  
TIGHTNESS OF ALL FIXINGS!**



**KIA EV9  
2023 onwards  
fits behind 2nd  
row of seats**

**G1691  
DOG GUARD  
FITTING INSTRUCTION**

**1**

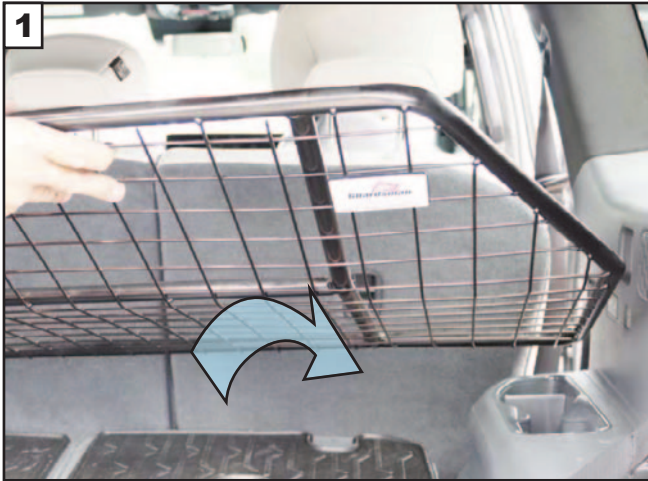

Move the second row of seats forward.  
Insert the Dog Guard as shown opposite.  
Lift the Dog Guard over the wheel arches.

**2**

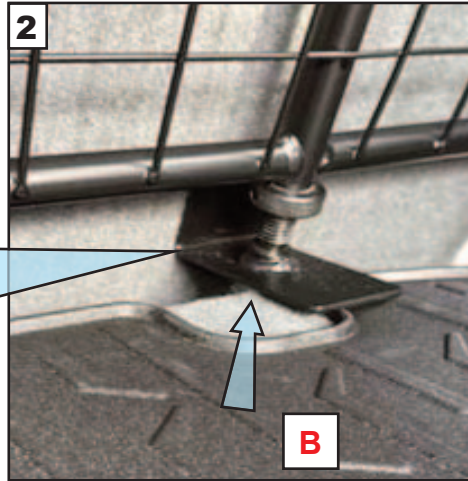

Insert the foot adjusters 'B' into  
the vertical tubes.

Bring the guard to the approximate  
final position

**3**



Use the appropriate  
controls to get the seat  
back rests into the  
position required.

The 2nd row seats need  
to be slid furthest back  
and the backrest furthest  
reclined

**4**

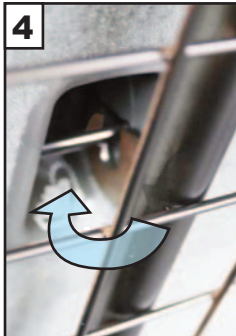

Hook the bracket under  
the 'child seat tether bar'  
and tighten Bracket 'B'  
upwards.

Ensure both sides are  
tightened equally

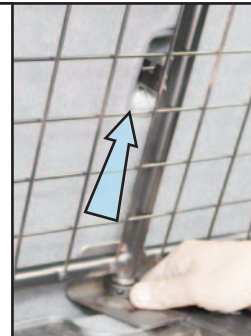

tel no. +44 (0)1827 713040  
www.guardsmantogguards.co.uk

Athag Ltd. 'GUARDSMAN'  
Carlyon Rd Ind Est. Atherstone  
England CV9 1HU  
+44 1827 713040

G1691 v1 05/24

**KIT**



READ FULLY  
BEFORE BEGINNING -  
IT'LL MAKE MORE  
SENSE!



**KIA EV9  
(2024 onwards)  
PART NO. G1691D**

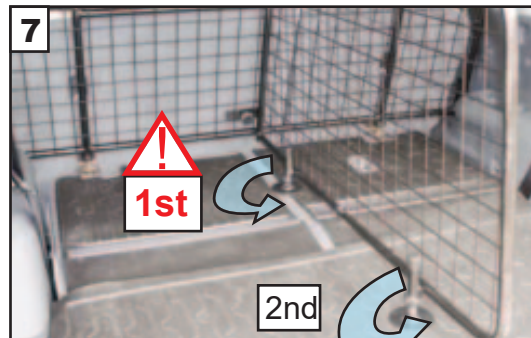
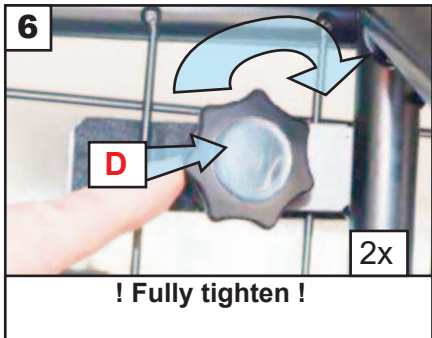
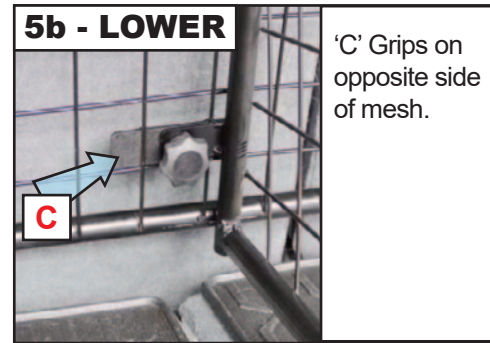
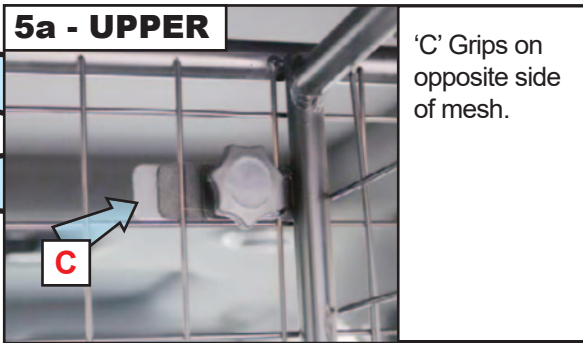
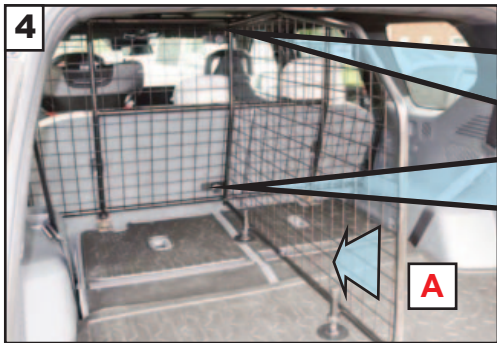
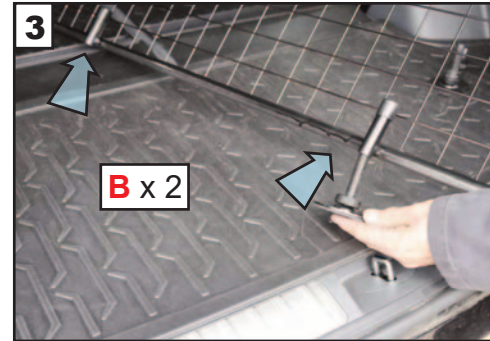
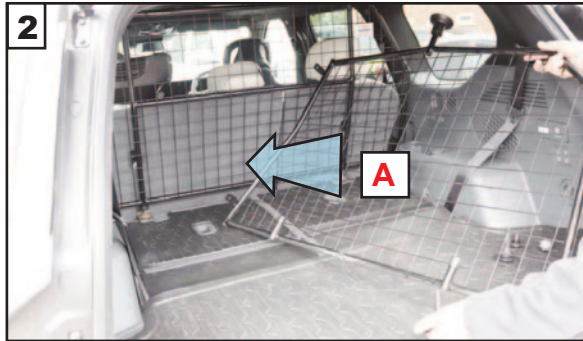

**VARIABLE BOOT DIVIDER  
FITTING INSTRUCTION**

CAN ONLY BE USED IN  
CONJUNCTION WITH  
'GUARDSMAN'  
**KIA EV9  
Dog Guard  
(2024 Onward)  
G1691**

Athag Ltd. 'GUARDSMAN'  
Carlyon Rd Ind Est. Atherstone  
England CV9 1HU  
+44 1827 713040

[www.guardsmandogguards.co.uk](http://www.guardsmandogguards.co.uk)



G1691D v.1 7/24